

**SMARTPILOT SURFACE MOUNT  
CONTROLLER INSTALLATION GUIDE**

**Parts supplied**

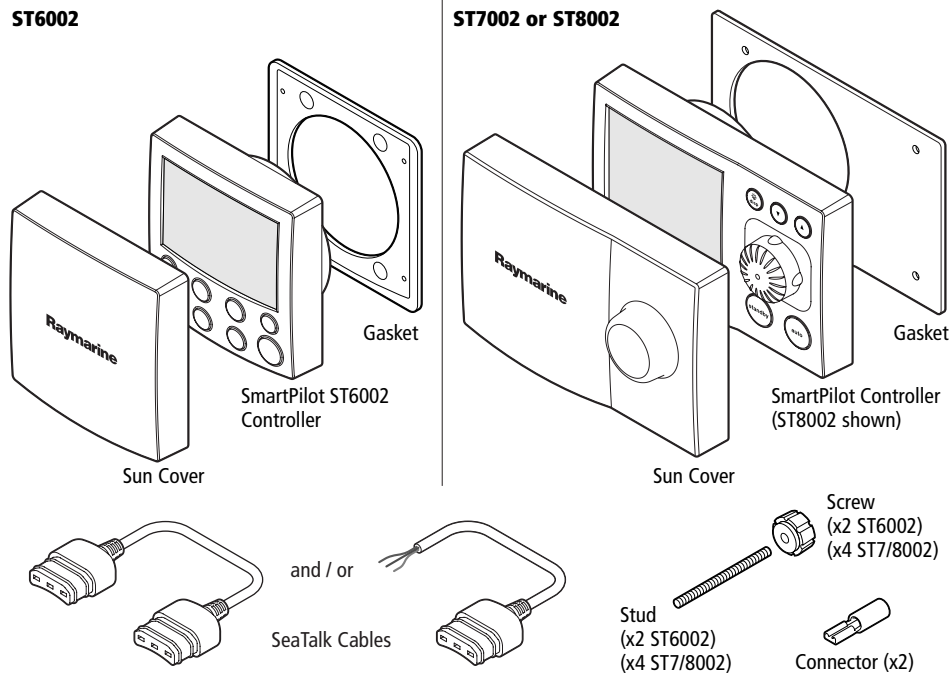

**Tools required**

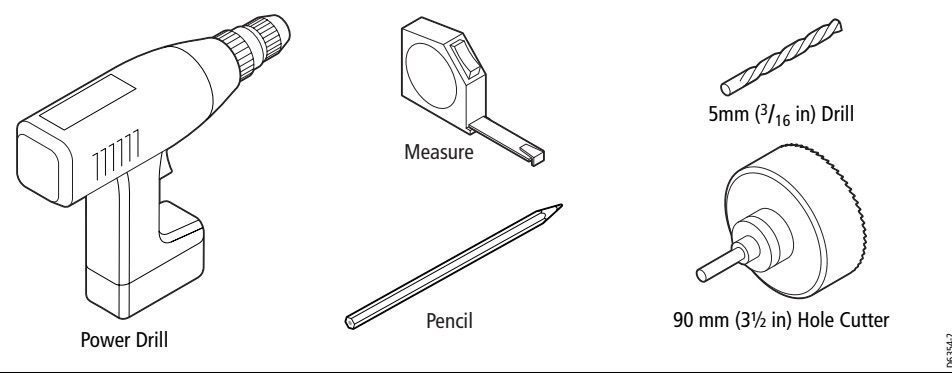

Raymarine Ltd, Portsmouth, Hampshire, UK PO3 5TD +44 (0) 23 9269 3611  
 Raymarine Inc. Merrimack, NH, 03054-4801, US Toll Free: 800-539-5539  
 Recyclable Material - Please dispose of responsibly. +1 603-881-5200

**Site requirements**

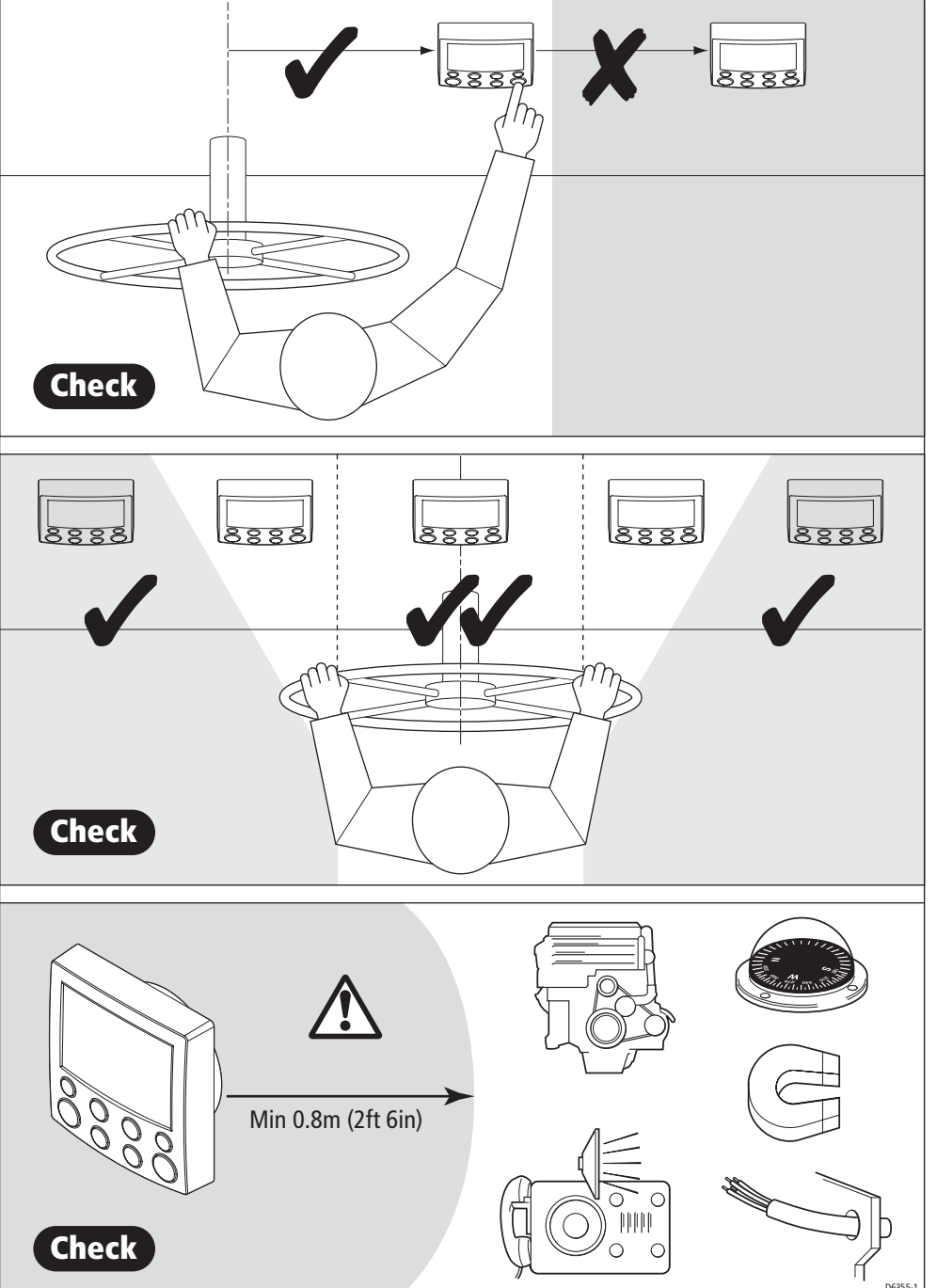

**ST6002 surface mount template**

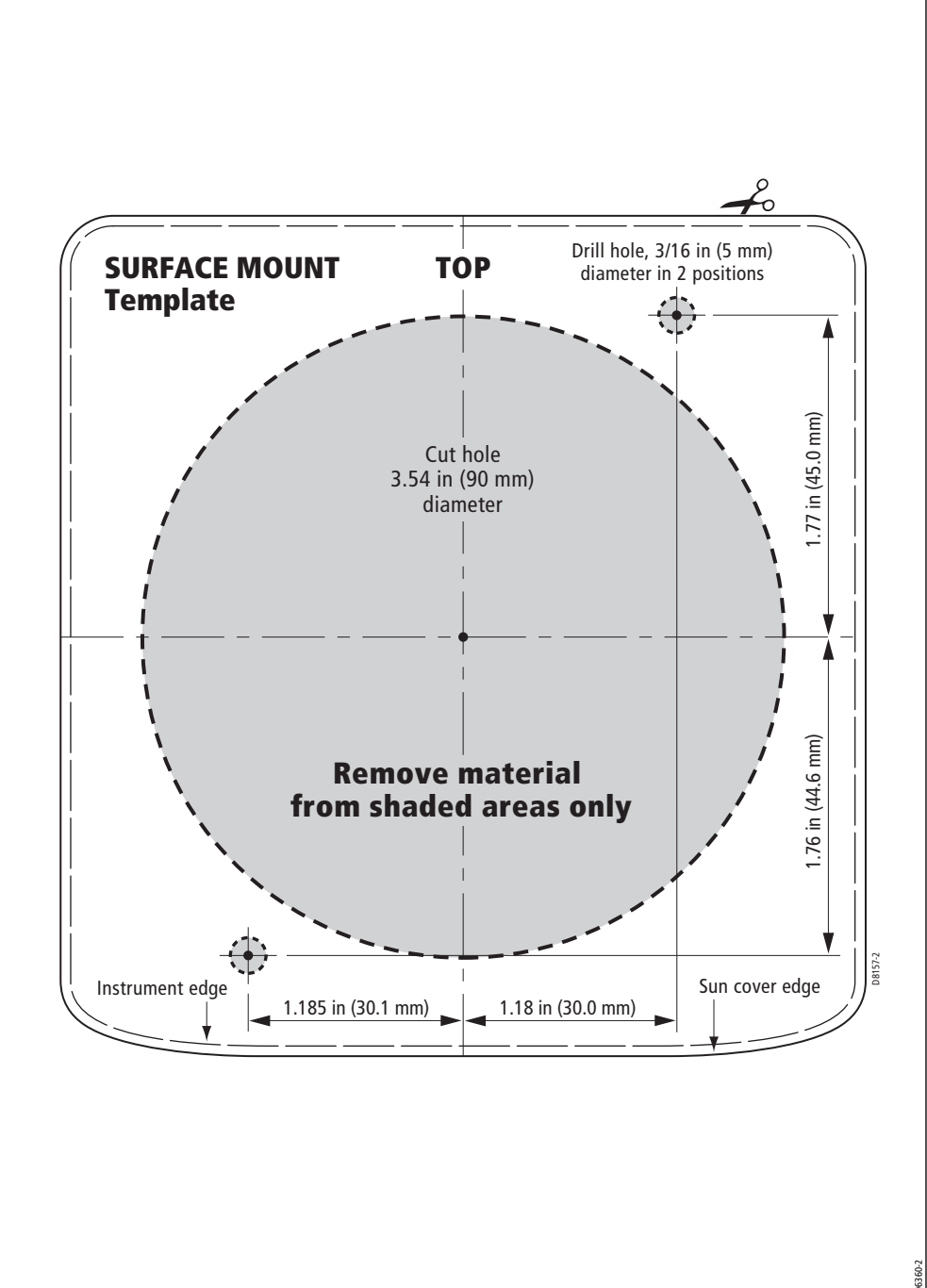

**ST6002 controller - Step 1**

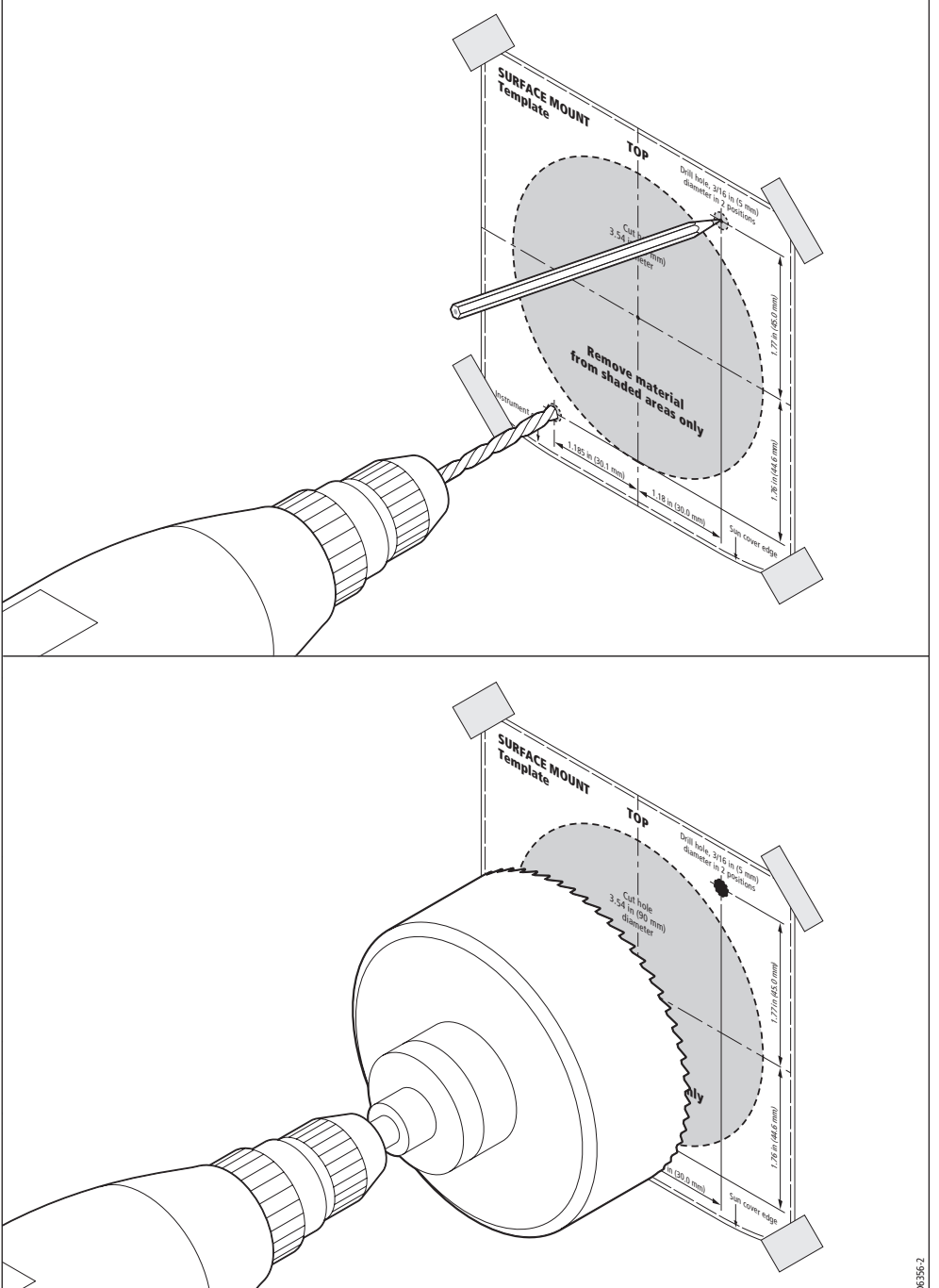

ST7002 and ST8002 controller - Step 1

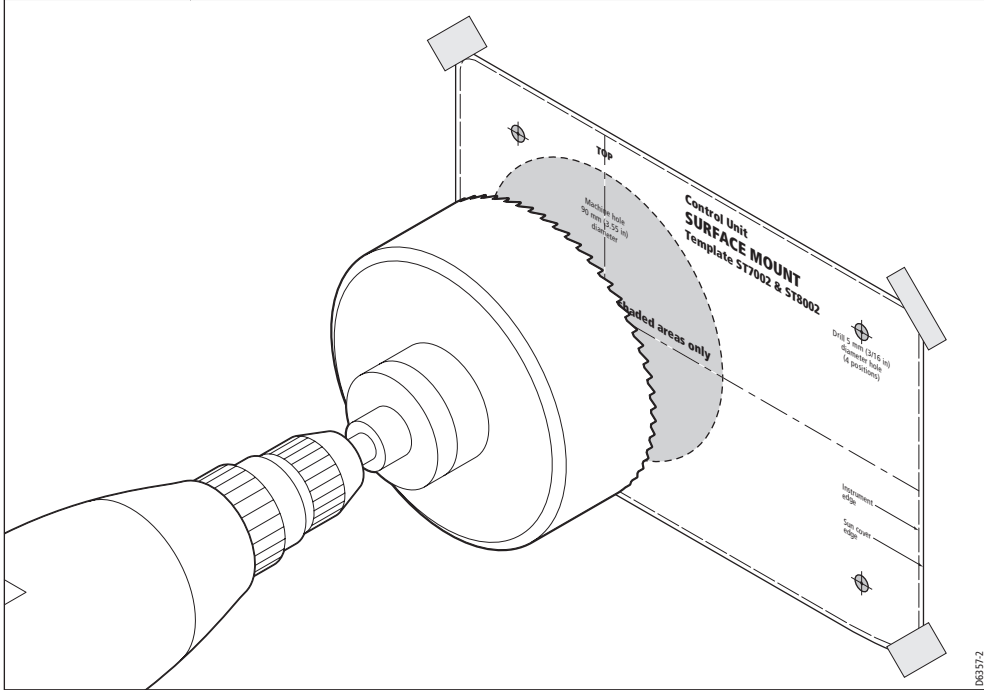
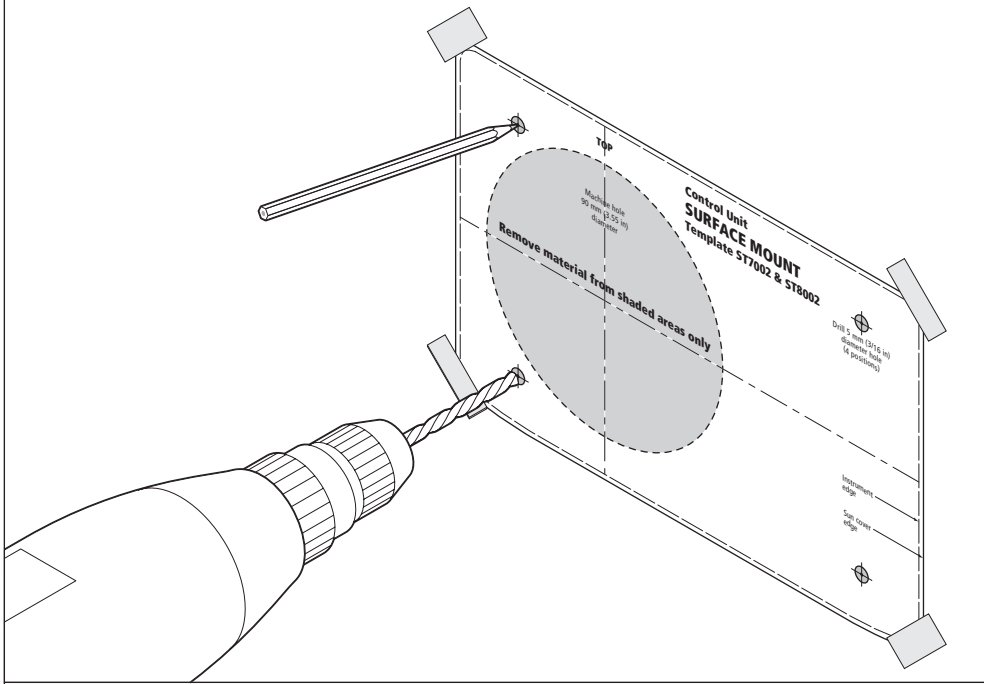

ST6002 - Step 2

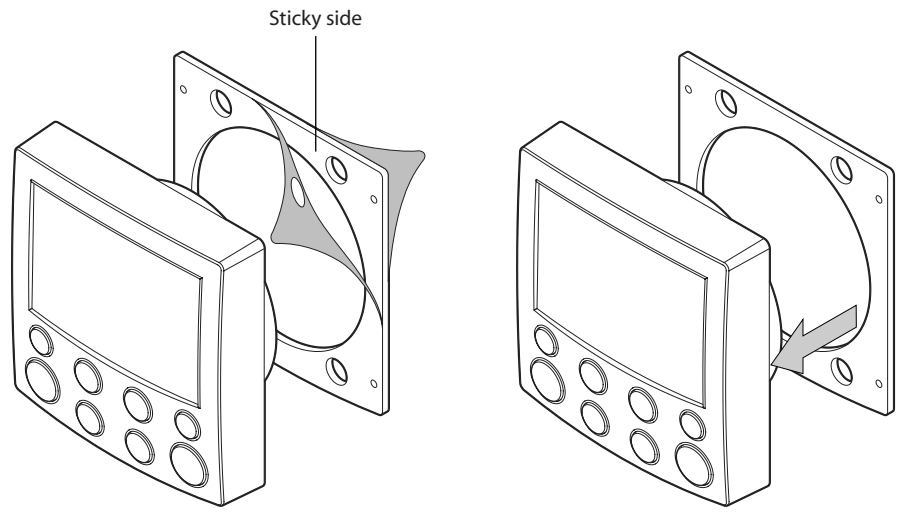

ST7002 and ST8002 - Step 2

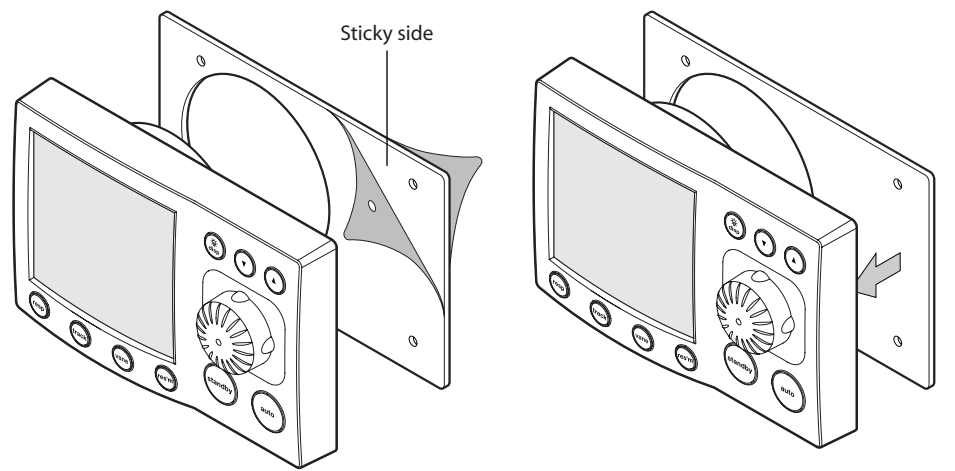

ST6002 - Step 3

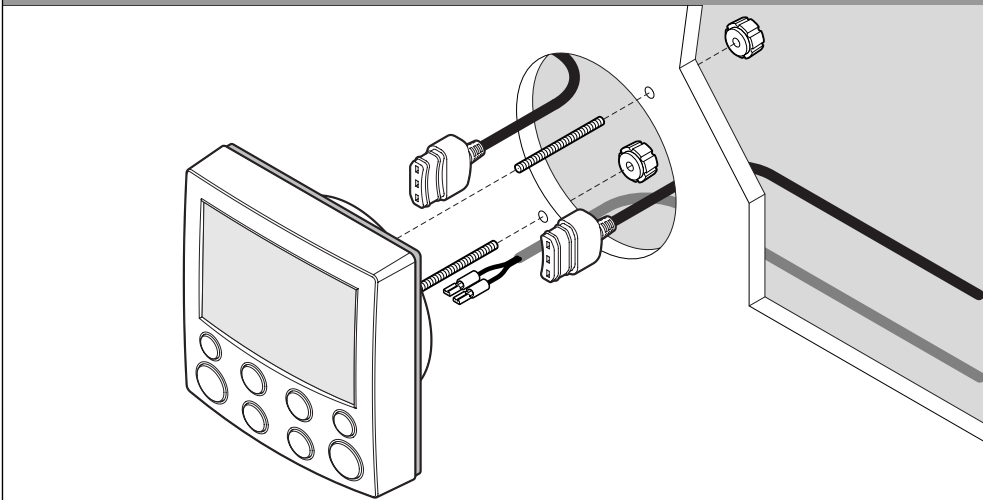

ST7002 and ST8002 - Step 3

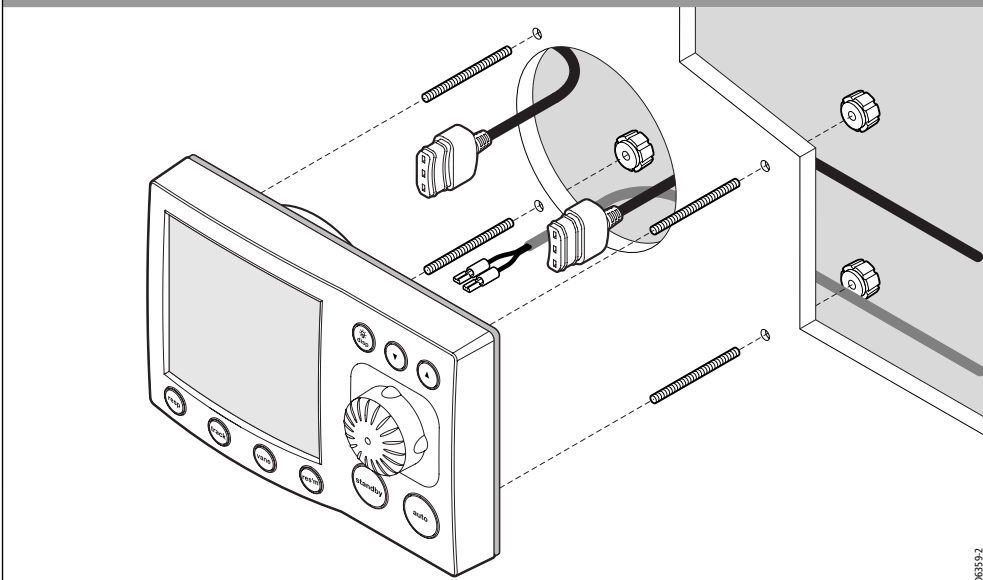

Refer to Autopilot Manual  
 Référez le manuel de pilote automatique  
 Siehe Autopiloten Handbuch  
 Refiérase al manual del piloto  
 Refiérase a manual de autopilot

ST7002 and ST8002 surface mount template

